



LAUREN
HENDRICKS
COMMERCIAL REALTOR

Windermere
COMMERCIAL

Office/Retail For Lease

6400 15th Ave NW, Seattle, WA 98107

Lauren Hendricks
Windermere Real Estate Midtown Commercial
(206) 999-9161
laurenhendricks@windermere.com
www.commercialseattle.com

The information contained herein was obtained from sources believed reliable; however, Lauren Hendricks makes no guarantees, warranties or representations as to the completeness or accuracy thereof. The presentation of this property is subject to errors, omissions, change of price or conditions prior to sale or lease, or withdrawal without notice.

Property Overview

6400 15th Ave NW | 1

Summary

Address: 6400 15th Ave NW, Suite # 130, Seattle, WA 98107

Size: 300 SF

Zoning: NC3P-55

Rate: \$25/SF/YR+ NNN

Estimated NNN: \$6/SF/YR Minimum 5

Terms: Year lease

Delivery Date: August 2022



Features & Highlights

6400 15th Ave NW | 2



Property Features:

- Separate Entrance
- Signage
- Fully Sprinklered
- Air Conditioning
- Separately Metered Utilities

93

Walk Score
Walker's Paradise

Daily errands do not
require a car.

54

Transit Score
Good Transit

Many Nearby public
transit options.

90

Bike Score
Biker's Paradise

Daily errands can be
accomplished on a bike.

Amenities Map

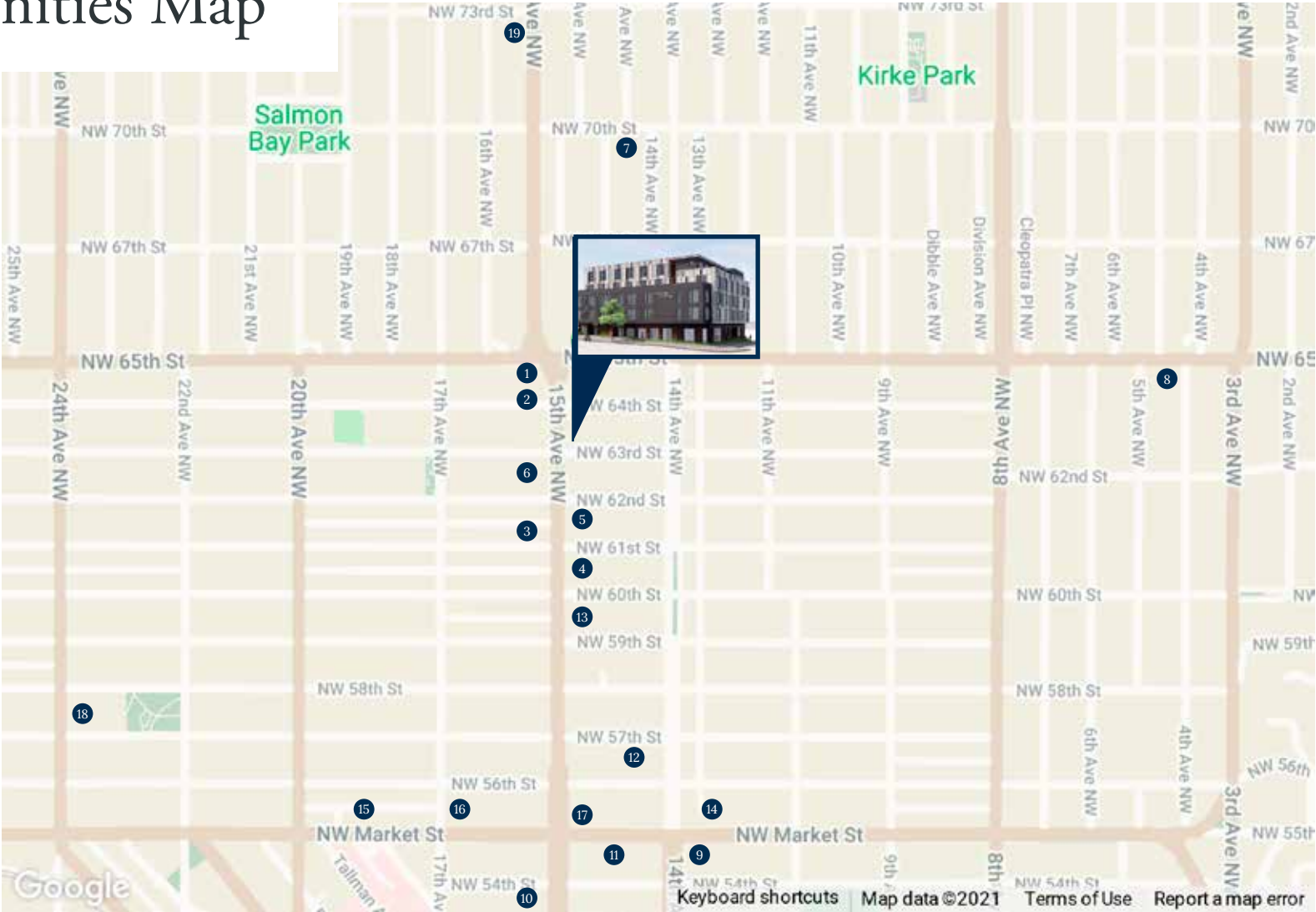

Neighborhood

- | | | | |
|---------------------------|-------------------|--------------------|----------------|
| 1. Ballard Crossfit | 6. Jiffy Lube | 11. Safeway | 16. 7/11 |
| 2. Ballard Pho & Teriyaki | 7. Frankie & Jo's | 12. Ballard Market | 17. Chase Bank |
| 3. Taco Del Mar | 8. Café Bambino | 13. Taco Bell | 18. QFC |
| 4. MOD Pizza | 9. Mcondalds | 14. KFC | 19. Midas |
| 5. US Bank | 10. Wendys | 15. Fed ex | |

Neighborhood Overview

Ballard/Fremont

Ballard / Fremont is one of the founding neighborhoods of Seattle. This submarket lines the north edge of the Lake Washington Ship Canal from the shores of Puget Sound all the way to the western edge of the University District.

This trendy neighborhood is overflowing with stylish restaurants, bars, boutiques and breweries. Being one of Seattle's oldest neighborhoods, it is also rich in Northwest maritime history. Several notable landmarks in the area include the Ballard Locks, National Nordic Museum and Golden Gardens Park.

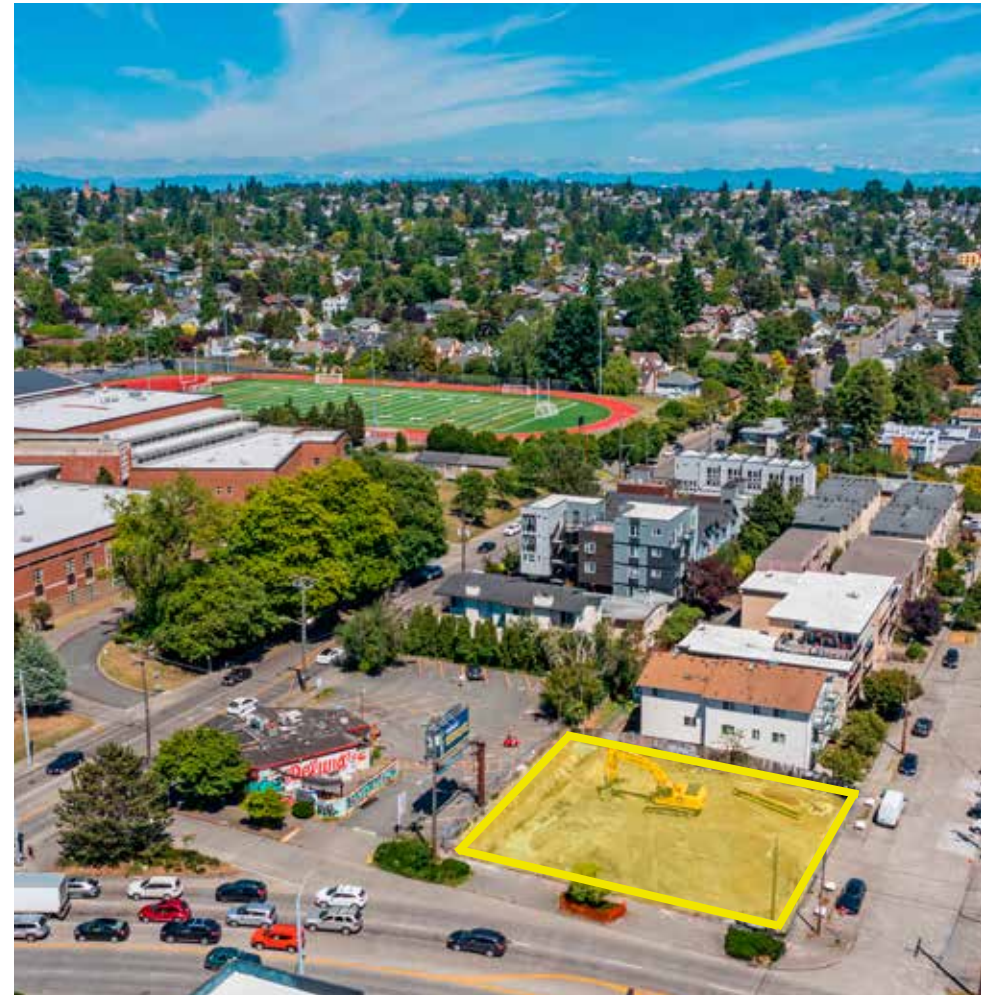

Photos



South Facing View

Floor Plans

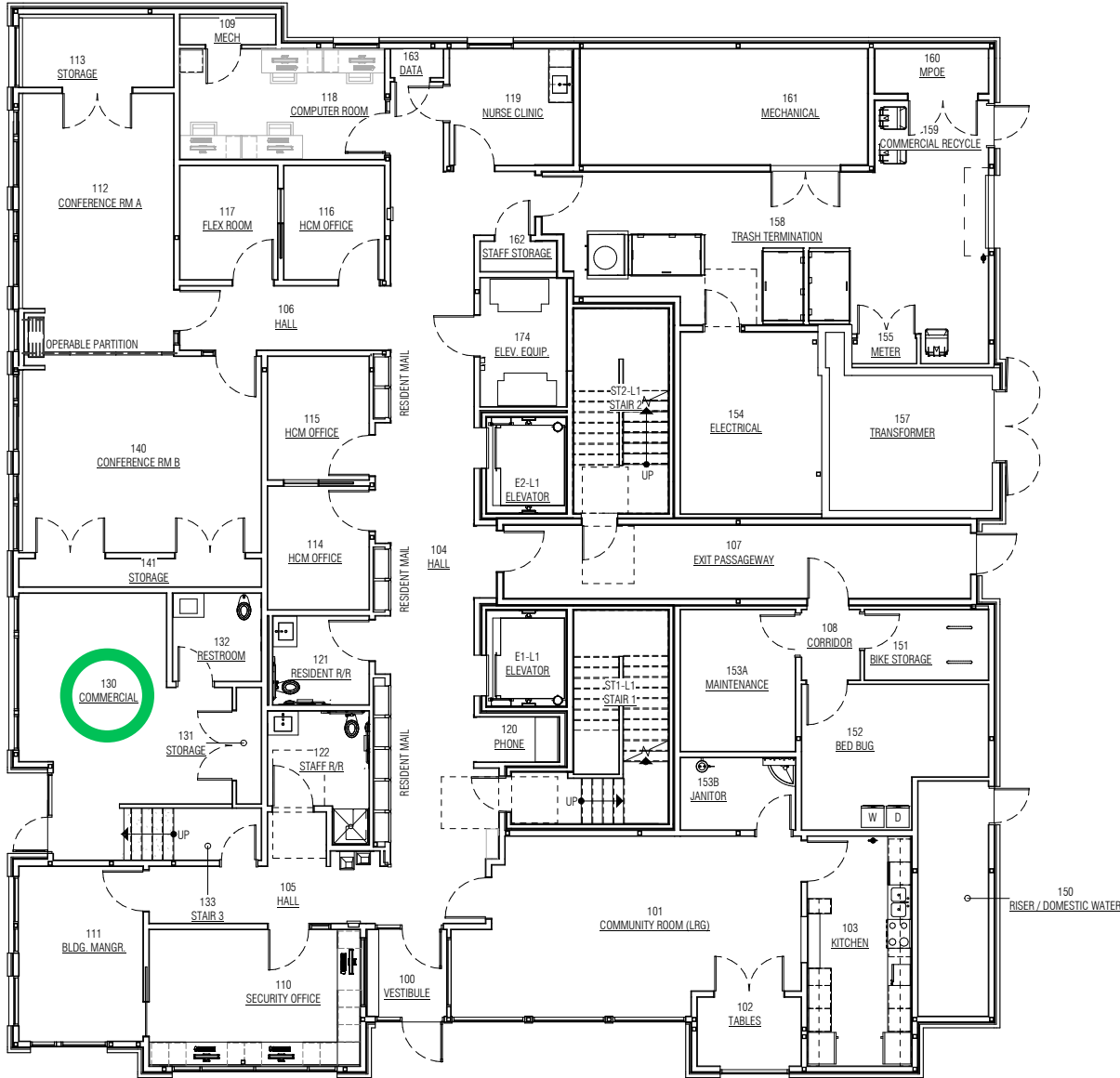



LAUREN
HENDRICKS
COMMERCIAL REALTOR



Windermere
COMMERCIAL

Contact

Lauren Hendricks
Windermere Real Estate Midtown Commercial
(206) 999-9161
laurenhendricks@windermere.com
www.commercialsattle.com